



DRAFT TOWER

TITAN L - 6 FAUCET

- Over-sized brewery pipe style (4" diameter) for the bar top
- U.S. manufactured
- Durable polished stainless steel finish provides years of service
- All stainless steel contact with the beer for the ultimate in draft purity



TT-L-6KR-11

Polished Stainless Steel

Faucet knobs not included.

 Certified by the National Sanitation Foundation



The integrated Kool-Rite module provides optimum cooling at the point of dispense. Modular construction makes the installation process as simple as PLUG "N" POUR.

www.micromatic.com • 1 (866) 327-4159

TITAN L - 6 FAUCET

Job Number: _____ Location: _____

| Part No. | Faucets | Finish | Dispense System | Shipping Weight |
|--------------------|---------|--------------|--------------------|-----------------|
| TT-L-6KR-11 | 6 | Polished S/S | Kool-Rite (Glycol) | TBD |

Dimensions

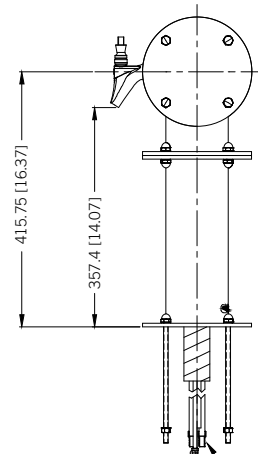
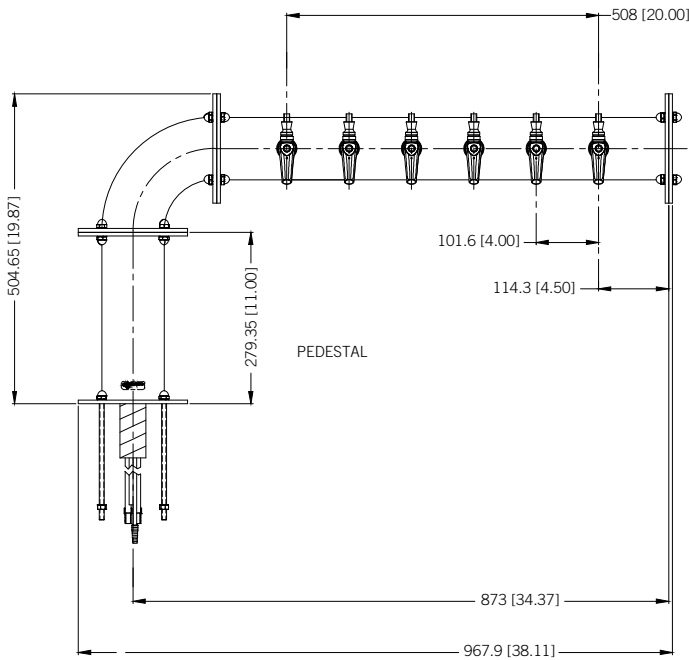
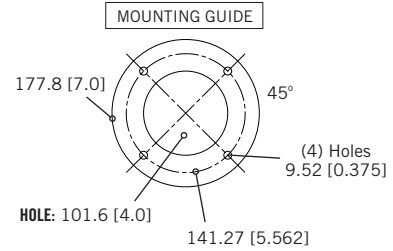
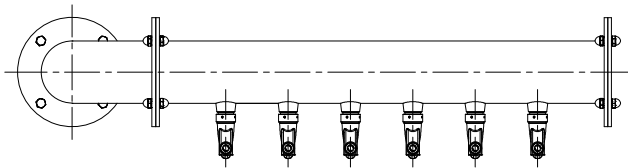

BEER:
6mm (1/4") O.D. Stainless Steel
with 6mm - 9.5mm (1/4" - 3/8") Barb Fittings

GLYCOL:
9.5mm (3/8") O.D. Copper
with 9.5mm (3/8") Barb Fittings

(6) BEER LINES 54" LONG
(1) GLYCOL LOOP WITH
(2) CONNECTIONS