

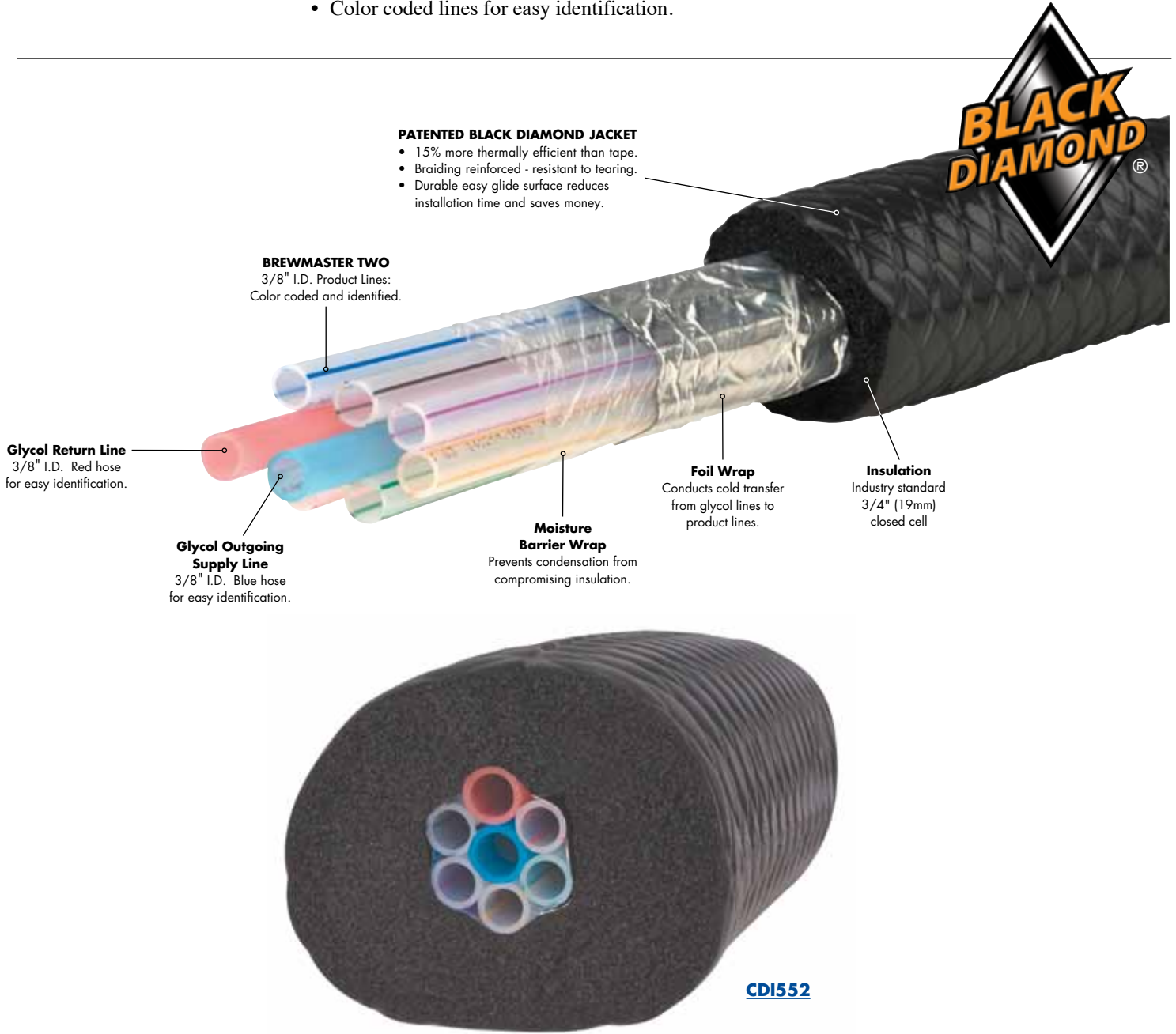

- Dependable delivery of cold beer from walk-in to tower.
- Black Diamond is 15% more thermally efficient than traditional tape jacket.
- Brewery Approved tubing.
- Color coded lines for easy identification.



## Features

 Standard 51 Listed  
Food Equipment Materials

# Specifications

Part No.	Description	Shipping Weight	Box Dimensions
<input type="checkbox"/> <a href="#">CDI552</a>	5 Product Lines/2 Glycol Lines	.27 kg (per 305mm)	TBD
		.60 lbs (per foot)	TBD

# Performance

<b>Product Lines</b>	7.94 mm I.D. (5/16" I.D.) Brewery Approved Brewmaster II Barrier Tubing
<b>Glycol Cooling Lines</b>	9.5mm I.D. x 12.7mm O.D. (3/8" I.D. x 1/2" O.D.) Polyethylene Tubing
	<b>Outgoing:</b> Blue Color Coded
	<b>Return:</b> Red Color Coded
<b>Moisture Barrier Wrap</b>	Food Quality Barrier Film
<b>Cold Transfer Wrap</b>	Aluminum Foil
<b>Insulation</b>	19mm (3/4") Closed Cell
<b>Black Diamond® Jacket</b>	15% more thermally efficient than tape. Braiding reinforced, resistant to tearing
<b>Exterior Marks</b>	Sequential Foot Marking, Every 610mm (2 Feet)
<b>Fire Rating</b>	Class 1 - Self extinguishing to BS3924, Class 1 when applied to insulation.
<b>Fire Rating</b>	Class 1 - Self extinguishing to BS3924, Class 1 when applied to insulation.

# Dimensions

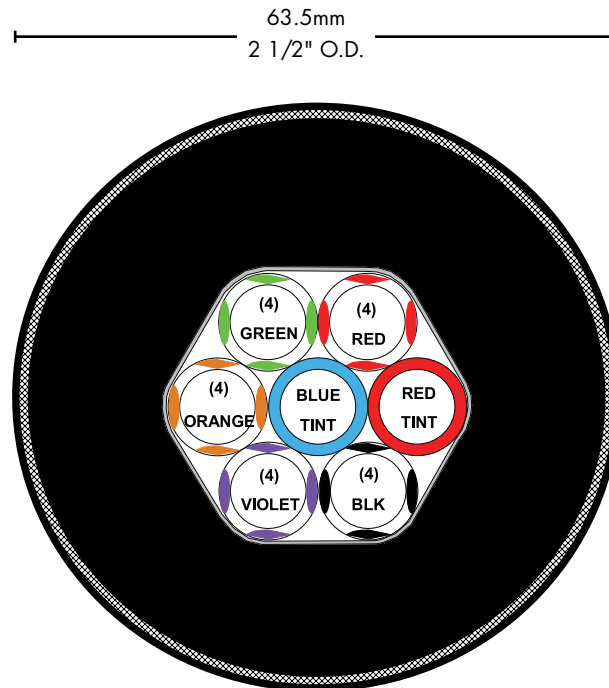

Copyright ©2012 Micro Matic USA, Inc. All Rights Reserved.

00154D0312



[www.micromatic.com](http://www.micromatic.com)

Toll Free: 1-(866) 327-4159

West	Central	Southeast	Northeast
19791 Bahama Street Northridge, CA 91324 Tel. (818) 701-9765 Fax. (818) 701-9844	10726 North Second Street Machesney Park, IL 61115 Tel. (815) 968-7557 Fax. (815) 968-0363	2364 Simon Court Brooksville, FL 34604 Tel. (352) 799-6331 Fax. (352) 796-2429	4601 Saucon Creek Road Center Valley, PA 18034 Tel. (610) 625-4464 Fax. (610) 625-4466